



# AVAILABLE



## Shopping Center Space for Lease



**Location:** 1020 – 1090 Westbank Expwy., Westwego, LA 70094

<b>Available:</b>	<b>Suite</b>	<b>Size</b>	<b>Rent</b>
	1026	1,320sf	\$14.75psf*
	1028	1,650sf	\$15.00psf*
	1030	3,450sf	\$12.00psf*
	1082	6,128sf	\$10.00psf*
	1074	19,188sf	\$5.00psf*

\* Plus net charges which are approx. \$3.10psf

**Tenant Mix:** Rent A Center, Pizza Hut, Tiffany Nails, Wego Nutrition, Jen Care, CSL Plasma, It's Fashion Metro, Beauty Supply, Estralita's Restaurant, Subway, Cricket Wireless, Armand's Daiquiri's and Joe's Café

**Possible Uses:** Grocery Store, Dental Office, Dollar Store, Hair Dresser, Shoe Store, Loan Company, Tax Office, Clothing Store, Employment Agency, etc

**Highlights:**  
» Well maintained Shopping Center with plenty of parking  
» Traffic Count ranges from 38,000 going west to 55,000 going east vpd

**JACK STUMPF  
& ASSOCIATES, INC.**

COMMERCIAL REAL ESTATE SERVICES

1700 Central Boulevard  
Harvey, Louisiana 70058  
(504) 366-6800  
www.jackstumpf.com

**Listing Agents:** Lloyd Giardina and Jon Cerruti  
(504) 366-6800

October 2024

The information presented herein has been furnished by the owner or obtained from sources we deem reliable. No warranties or representations, either expressed or implied are made as to the accuracy of the data provided, and same is subject to error, omission, change of price, and/or conditions of availability without notice.





UNIT ADDRESS	S.F.
1020-A	1,580
1020-B	1,610
1020-C	1,400
1020-D-E	1,540
1022	1,138
1024	1,427
1026	AVAILABLE 1,320
1028	AVAILABLE 1,650
1030	AVAILABLE 3,450
1036	4,500

UNIT ADDRESS	S.F.
1046	11,960
1050	10,858
1070	11,215
1072	11,360
1074-1078	AVAILABLE 19,188
1080-A	1,250
1080-B	1,250
1082	AVAILABLE 6,182
1088	1,296
1090	4,500

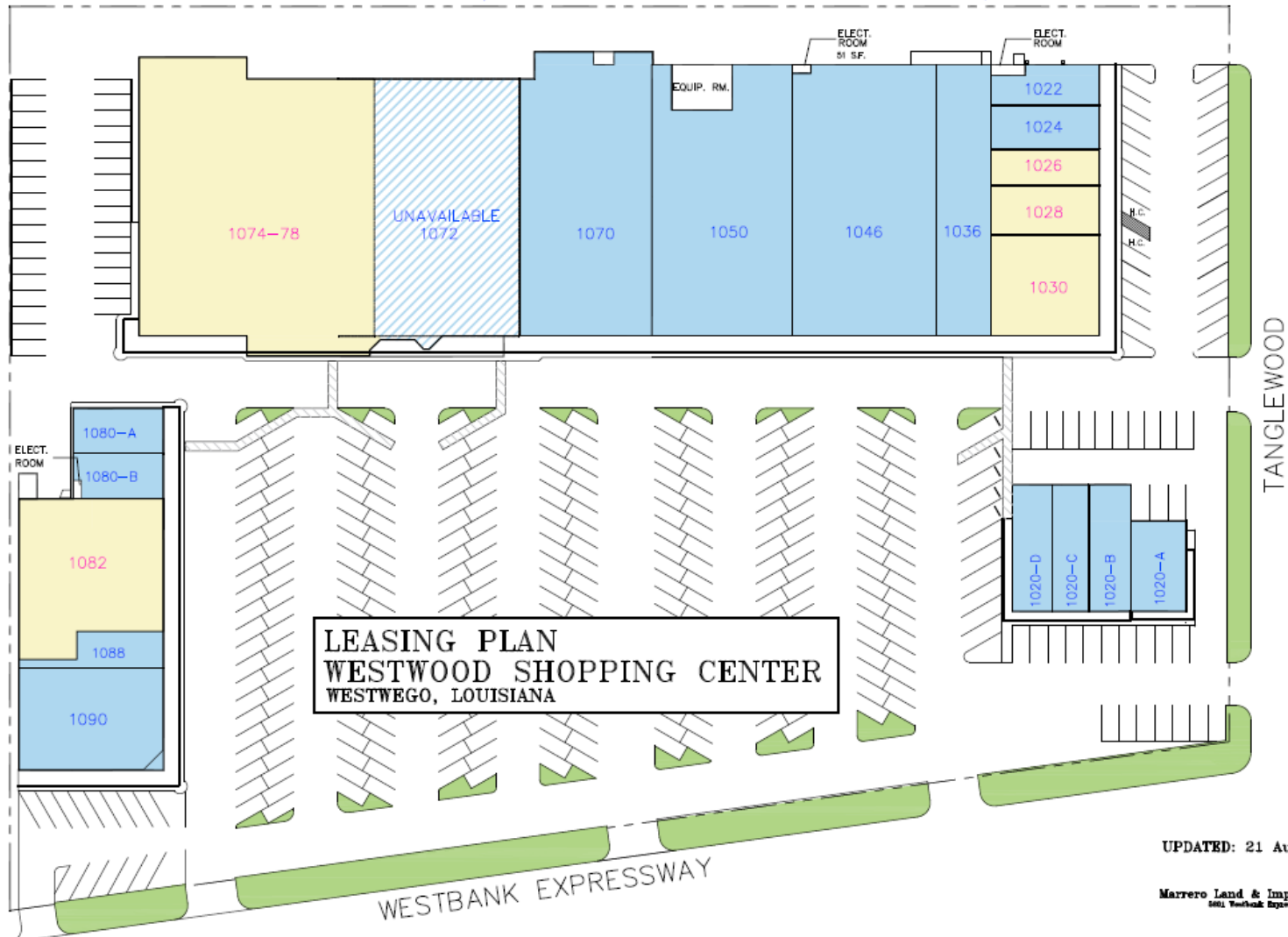

- LEASED
- AVAILABLE
- COMMON AREA



UPDATED: 21 August 2024

Marrero Land & Improvement Association, Ltd.  
5801 Westbank Expressway • Marrero, La. 70072

